

NCC COMPLIANT AS5216 CONFORMING

CHEMICAL INJECTION **BREMFIX** VINYLESTER

Range M8 - M24

Zinc Plated Studs
Dry, internal applications

FEATURES & BENEFITS

- Ideal for safety critical applications.
- Intended working life of 50 years.
- ETA rating - Option 1 for cracked concrete.
- VOC A+ rating.
- WRAS Approved for potable drinking water.
- LEED Compliance.
- Suitable for dry, wet & flooded holes.
- Fast cure time.

APPLICATIONS/TRADES

- Structural steel connections to concrete.
- Road, tunnel & bridge heavy construction.
- Cracked concrete applications.
- Fast turnaround time structural connections.

COMPLIANCE



**ZINC
YELLOW**



AS5216



OPTION 1
Cracked Concrete

CHEMICAL INJECTION

BREM/FX VINYLESTER

NCC COMPLIANT | AS5216 CONFORMING

RANGE

Chemical Injection - Product Code & description	Anchor thread size	ETA Cert'n level	# fixings per cartridge (per below Range tables)	
			300ml	410ml
ACIPCVR3002 BremFix Vinylester Chemical Injection - 300ml cartridge Use dispensing tool TMACISF4002	M8 (10 x 80mm hole)	Option 1 - Cracked Concrete	75	100
	M10 (12 x 90mm hole)		50	67
	M12 (14 x 110mm hole)		32	42
ACIPCVR4102 BremFix Vinylester Chemical Injection - 410ml cartridge Use dispensing tool TMACICG3802	M16 (18 x 125mm hole)		20	26
	M20 (22 x 170mm hole)		12	15
	M24 (28 x 210mm hole)		6	8

Chemical Anchor Stud - Product Code	Pack Qty	Thread size	Anchor length (mm)	Drill hole Ø (mm)	Drill hole depth (mm)	Minimum concrete thickness (mm)	Maximum fixture thickness (mm)	Fixture clearance hole Ø (mm)
			l_t	d_o	h_1	h_{min}	$t_{fix, max}$	d_f

Chemical Anchor Studs (Property Class 5.8)

ACSMZ081102	10	M8	110	10	80	110	15	10
ACSMZ101302	10	M10	130	12	90	120	20	12
ACSMZ121602	10	M12	160	14	110	140	25	14
ACSMZ161902	10	M16	190	18	125	155	35	18
ACSMZ202602	5	M20	260	22	170	215	50	22
ACSMZ243002	5	M24	300	28	210	270	55	26

Flat Cut Chemical Anchor Studs (Property Class 5.8)

SFCMZ121602	10	M12	160	14	110	140	25	14
SFCMZ161902	10	M16	190	18	125	155	35	18
SFCMZ202602	5	M20	260	22	170	215	50	22

CHEMICAL INJECTION

BREMFIX VINYLESTER

NCC COMPLIANT | AS5216 CONFORMING

INSTALLATION

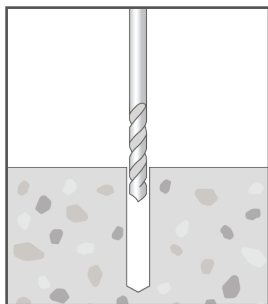

Drill hole into substrate to the specified diameter and depth using a rotary hammer drill and correctly sized carbide bit.

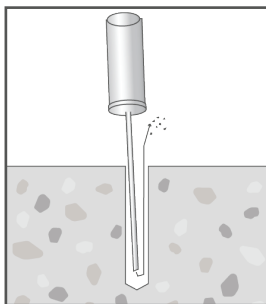

Blow out from the base of the drill hole at least 4 times until removed air is free of noticeable debris. For drill holes up to 22mm diameter - a manual blower pump may be used to clean the hole. For larger diameter holes - compressed air cleaning must be used and may also be used for smaller holes.

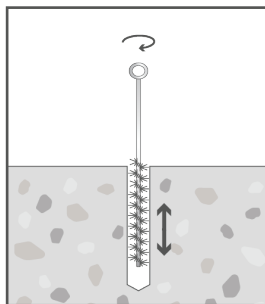

Brush 4 times with a wire brush (its diameter should be greater than the drill hole diameter) - inserting the brush to the base of the hole and withdrawing it with a twisting motion. If no resistance is felt during this step, the brush is worn - replace it.

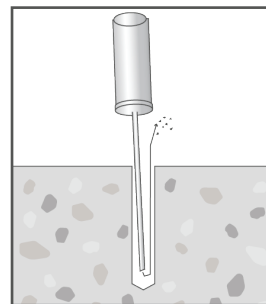

Blow out again at least 4 times.

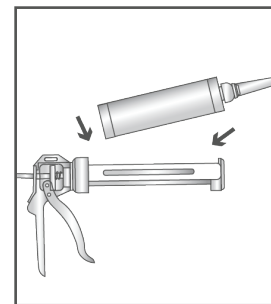

Insert the cartridge into the dispenser and screw the correct mixing nozzle onto the cartridge.

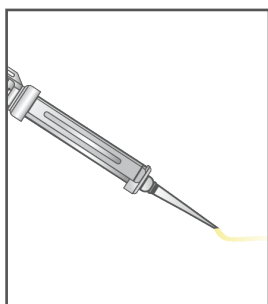

Prior to dispensing into the anchor hole, squeeze out a 10cm length bead of material and discard. The adhesive should now have a consistent, uniform color indicating correct mixing is occurring.

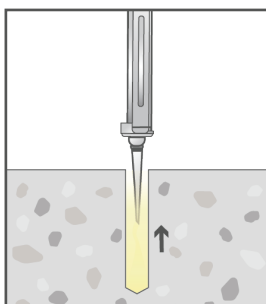

With the cartridge nozzle tip at the base of the cleaned drill hole, inject adhesive until the hole is approximately 2/3 full. Slowly withdraw the nozzle from the hole whilst injecting, keeping the nozzle tip immersed in the adhesive. This will avoid creating air pockets within the adhesive.

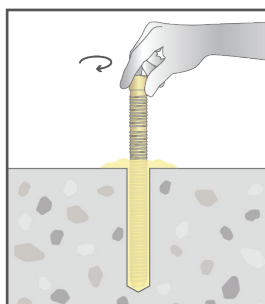

Ensure the anchor stud is clean and free of contaminants, grease etc. Push the anchor stud into the adhesive - slowly rotating the stud until it is seated against the base of the hole. An excess of adhesive around the top of the hole indicates sufficient material was injected into the hole, otherwise remove the anchor stud and renew the hole with adhesive.

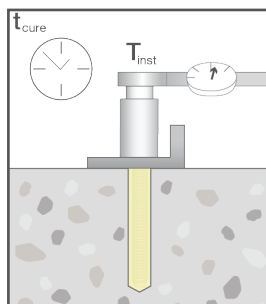

All steps prior must be completed within the working time of the adhesive. Protect the anchor from disturbance until the full curing time has been reached. Once full cure is achieved, carefully place the fixture and apply the specified installation torque.

CHEMICAL INJECTION

BREMFIX VINYLESTER

NCC COMPLIANT | AS5216 CONFORMING

PRODUCT INSTALL & PERFORMANCE INFORMATION

Chemical Anchor Stud - Product Code	Anchor length (mm)	Maximum fixture thickness (mm)	Drill hole depth (mm)	Minimum concrete thickness (mm)	Socket size AF (mm)	Installation torque (Nm)	Design Capacities	
							Uncracked concrete - tension (kN)	Uncracked concrete - shear (kN)
	l_t	$t_{fix, max}$	h_1	h_{min}	SW	T_{inst}	N_{Rd}	V_{Rd}

Chemical Anchor Studs (Property Class 5.8)

ACSMZ081102	110	15	80	110	13	10	11.9	7.2
ACSMZ101302	130	20	90	120	17	20	16.9	11.8
ACSMZ121602	160	25	110	140	19	40	24.8	16.8
ACSMZ161902	190	35	125	155	24	60	30.6	31.2
ACSMZ202602	260	50	170	215	30	120	49.4	48.8
ACSMZ243002	300	55	210	270	36	160	64.0	70.4

Chemical Anchor Flat Cut Studs (Property Class 5.8)

SFCMZ121602	160	25	110	140	19	40	24.8	16.8
SFCMZ161902	190	35	125	155	24	60	30.6	31.2
SFCMZ202602	260	50	170	215	30	120	49.4	48.8

Note:

Installation in accordance with this information.

Concrete cylinder compressive strength of 32MPa.

Single anchor capacity – no nearby concrete edge with minimum recommended concrete thickness.

In service temperature range I considered, hammer drilled holes.

$\psi_{sus} = 1$, refer to AS 5216:2021 clause 6.2.5.2 for details.

To address specific design cases, please refer to the product ETA document and contact Bremick for details.

Important Disclaimer: Product performance information contained herein is based on ETA certificate data and AS5216:2021 inputs as appropriate. Capacity information is limited to very simple load case configurations and is provided to enable a relative comparison within and across product ranges. The design of an anchoring solution for a particular application should be conducted by an appropriately qualified design professional.

MINIMUM CURING TIMES

Temperature in the concrete substrate	Gel / working time	Minimum curing time - dry concrete hole	Minimum curing time - wet concrete hole
$0^{\circ}\text{C} \leq \text{substrate} < 10^{\circ}\text{C}$	20 minutes	90 minutes	180 minutes
$10^{\circ}\text{C} \leq \text{substrate} < 20^{\circ}\text{C}$	9 minutes	60 minutes	120 minutes
$20^{\circ}\text{C} \leq \text{substrate} < 30^{\circ}\text{C}$	5 minutes	30 minutes	60 minutes
$30^{\circ}\text{C} \leq \text{substrate} < 40^{\circ}\text{C}$	3 minutes	20 minutes	40 minutes
Cartridge / adhesive temperature $\geq 20^{\circ}\text{C}$			

Whilst every care was taken in the preparation of this publication, Bremick® accepts no responsibility for the accuracy of the information supplied. Bremick® reserves the right to make alterations to product specifications as part of ongoing product development and improvement. This publication serves as a guide and it's the responsibility of the end user to ensure product suitability for their application. The contents of this publication are the exclusive copyright of Bremick® and may not be reproduced without permission.

BREMICK®

Bremick Pty Ltd
Head Office | 88 Dalmeny Avenue, Rosebery 2018
National Distribution Centre | M5/M7 Logistics Park,
Warehouse 4B, 290 Kurrajong Road, Prestons NSW 2170
www.bremick.com.au