

NON SAFETY CRITICAL

THREADED ROD HANGER CONCRETE FIXING

M10 size

Zinc Plated
Dry, internal applications

FEATURES & BENEFITS

- Suitable for M10 threaded rod
- Vertical mount
- Fast to install

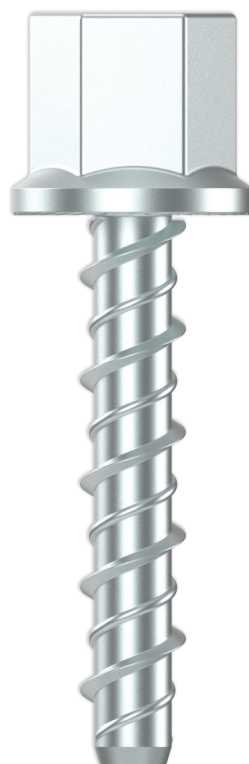

Hex shaped head for easy installation

Hi Lo thread, reduces torque during installation.

**ZINC
PLATED**

APPLICATIONS/TRADES

- Suspending threaded rod
- Suspending conduit
- HVAC ductwork and strut channels
- AC ducting
- Hanging pipe
- Cable tray applications

SUBSTRATE SUITABILITY

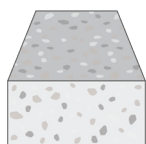

UNCRACKED
CONCRETE

THREADED ROD HANGER - CONCRETE FIXING

NON SAFETY CRITICAL

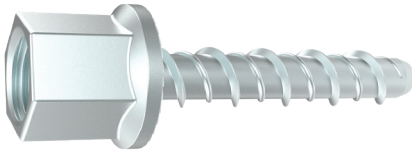

RANGE

Product Code	Pack Quantity	Version	Drill hole Ø (mm)	Socket Size AF (mm)	To suit threaded rod	Embedment Depth (mm)
			d ₀	SW		
AVHCZ060382	100	Vertical	6	13	M10	38mm

INSTALLATION

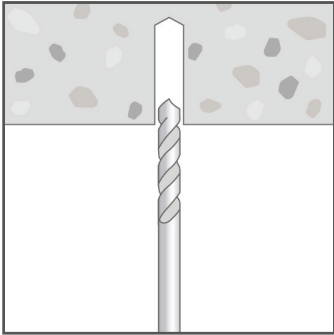

Drill hole through fixture into substrate to the specified diameter and depth.

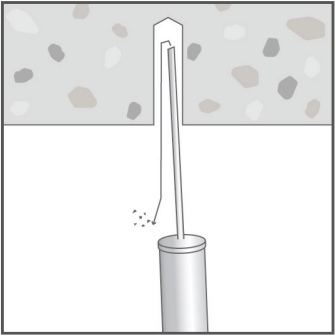

Clear hole of drilling debris.

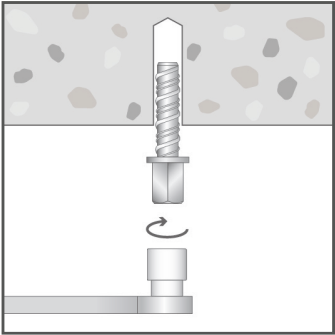

Insert anchor into hole and screw in using spanner, socket or an impact wrench. Apply constant forward pressure when driving. Ensure the underside of the anchor is flush with the base material.

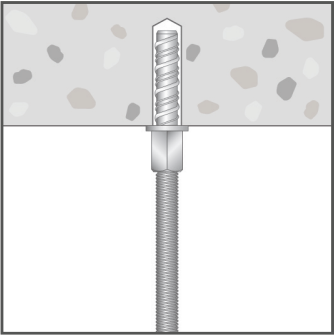

When attaching threaded rod to the hanger ensure its fully threaded into the anchor. Secure rod with M10 nut for additional security.